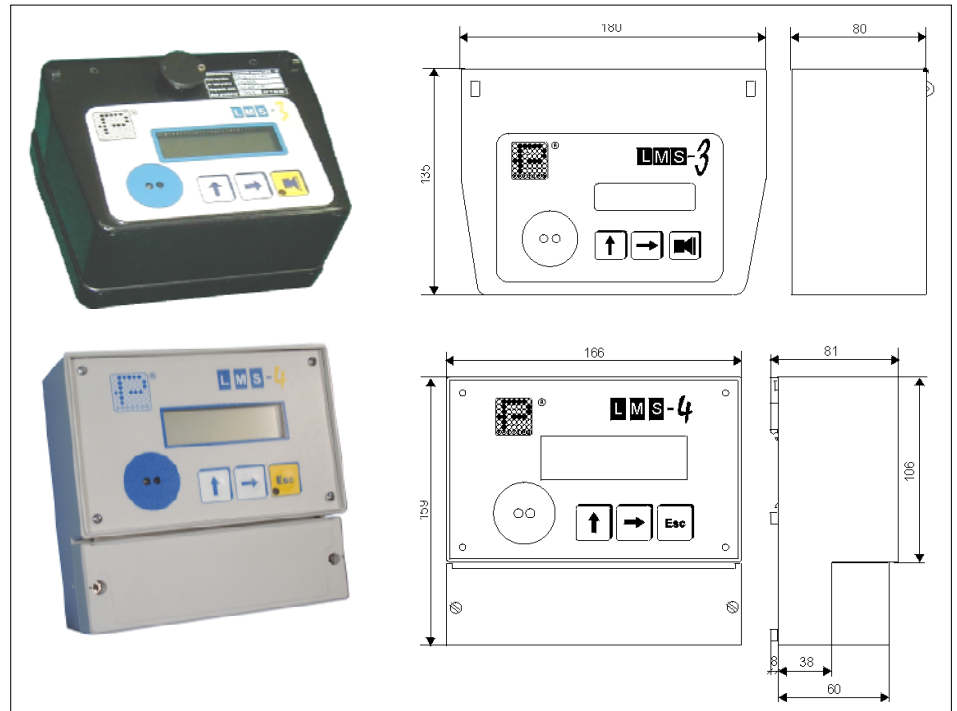
**LMS - maximum demand control unit****Type: LMS-3, LMS-3/S, LMS-4/S**

**LMS** is the maximum demand control unit designed for power, energy and maximum demand registration. The unit can be connected to any electricity meter (electromechanical or electronic), equipped with pulse output. LMS-3/S and LMS-4/S may be used as power controlling unit which signals exceeding of the power value which has been previously defined. The indicator is equipped with relay output which is activated when the predefined power value is exceeded. Measuring data may be read from LMS using communication interface RS232-OPTO or optionally via the CLO interface which is available when remove the cover of the terminal block. LMS-3 and LMS-3/S indicator can be equipped with two types of housing: the first one may be used for installing on the terminal block of the meter; the second one allows the unit to be installed directly on the measuring panel. LMS-4/S may also be installed on the rail TH-35.

**Functionality:**

- maximum demand measurement applying 15, 30 or 60 minutes integration period.
- Measuring data registration and presentation on LCD (measuring data for current billing period and historical values for last 12 billing periods are available).
- Readout of measuring data and configuration parameters
- manual or automatic reset of billing period (the automatic reset of billing period may be performed on the specific day, defined by the utility).
- relays and OC outputs gives the possibility of:
  - optical and sound signaling of exceeding of predefined power value
  - optical and sound signaling of exceeding of contractual power value
  - optical and sound signaling of measurement voltage decay
- Data transmission may be realized using RS232- OPTO interface or optionally by CLO interface which gives possibility of local and remote data readout as well as changing settings and parameters.

LMS power indicator is able to cooperate with communication module MKI-sm which gives possibility of remote data readout ( power threshold, contractual power value, cumulated power, exceeded value, date and time). When using a specially designed SOLEN software, applying the MKi transmission module connected to the local area network (i.e. ethernet) it is possible to configure the value of contractual power and power threshold value.

**This device fulfils requirements of European Directive 89/336/EEG and is given CE certificate.**

